

# 1 Pace Plaza East Renovation

Space Program Allocation  
Schematic Blocking Diagram Updates  
02/03/2023



**fx**collaborative

# Total Requested Programs for 1PPE Renovation

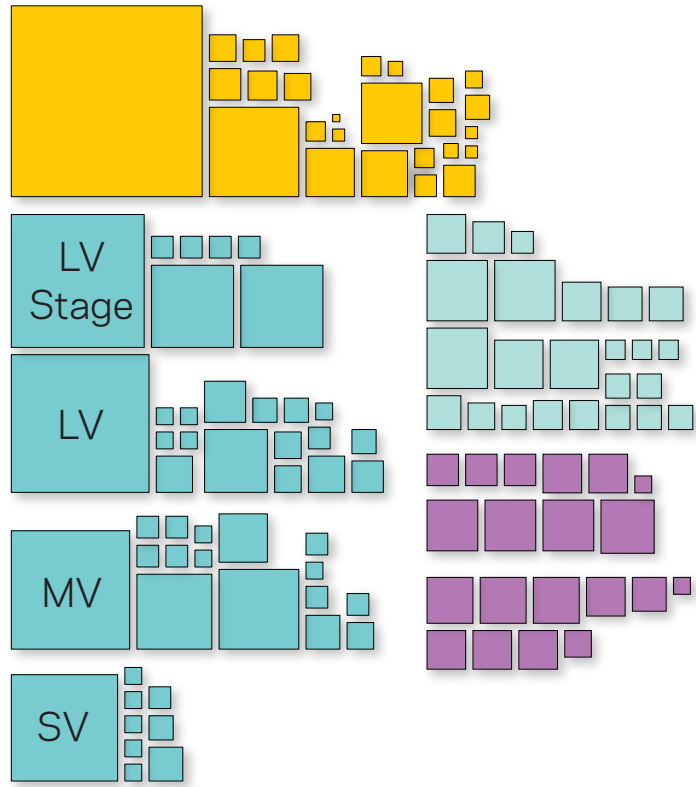

**Theaters + Support Spaces:**  
41,196 NSF

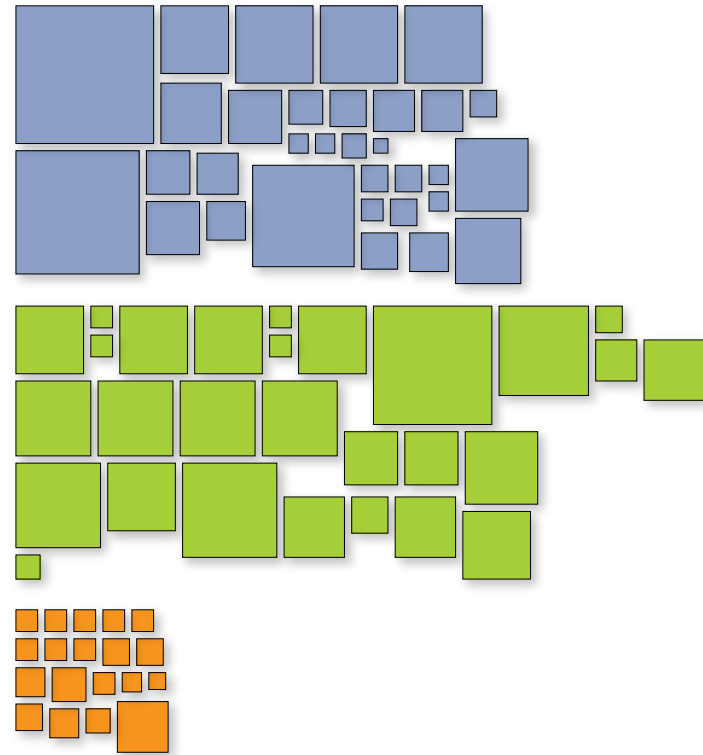

**PPA / ASDS:**  
40,873 NSF

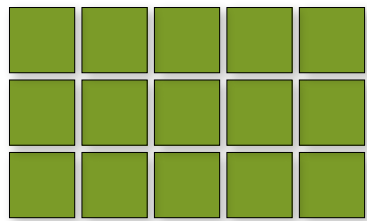

**Academic Classrooms:**  
10,875 NSF

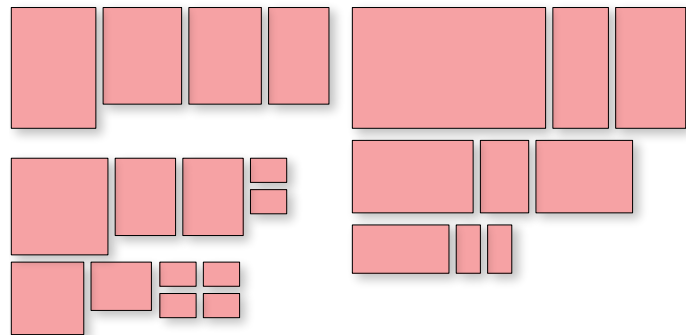

**Creative Arts:**  
21,850 NSF

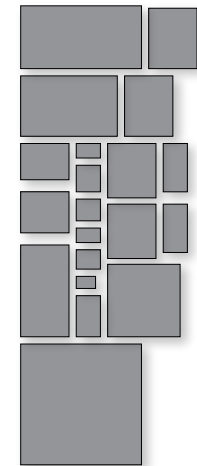

**Non-Academic:**  
10,084 NSF



**Non-Academic  
(Food Service):**  
3,325 NSF

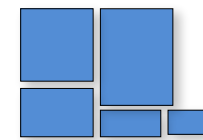

**University-wide  
Makerspace:**  
3,225 NSF

- PUBLIC AREAS
- EVENT/THEATER SPACES
- STAGE SUPPORT
- THEATER SUPPORT
- PRODUCTION SHOPS
- PPA/ASDS EDUCATION
- PPA/ASDS FACULTY OFFICES
- CREATIVE ARTS
- GENERAL CLASSROOMS
- NON-ACADEMIC
- UNIVRESITY-WIDE MAKERSPACE

Total Program Request: 131,428 NSF  
**+/-1.6 Grossing Factor: 210,285 GSF**

- Circulation
- Bathrooms
- Mechanical Spaces
- Structure / Wall Thicknesses
- Stairs / Elevators

Available Area at 1PPE: 180,217 GSF  
 w/ double-height spaces subtracted: **163,750 GSF**

**DELTA: 46,535 GSF**

# Sectional Challenges

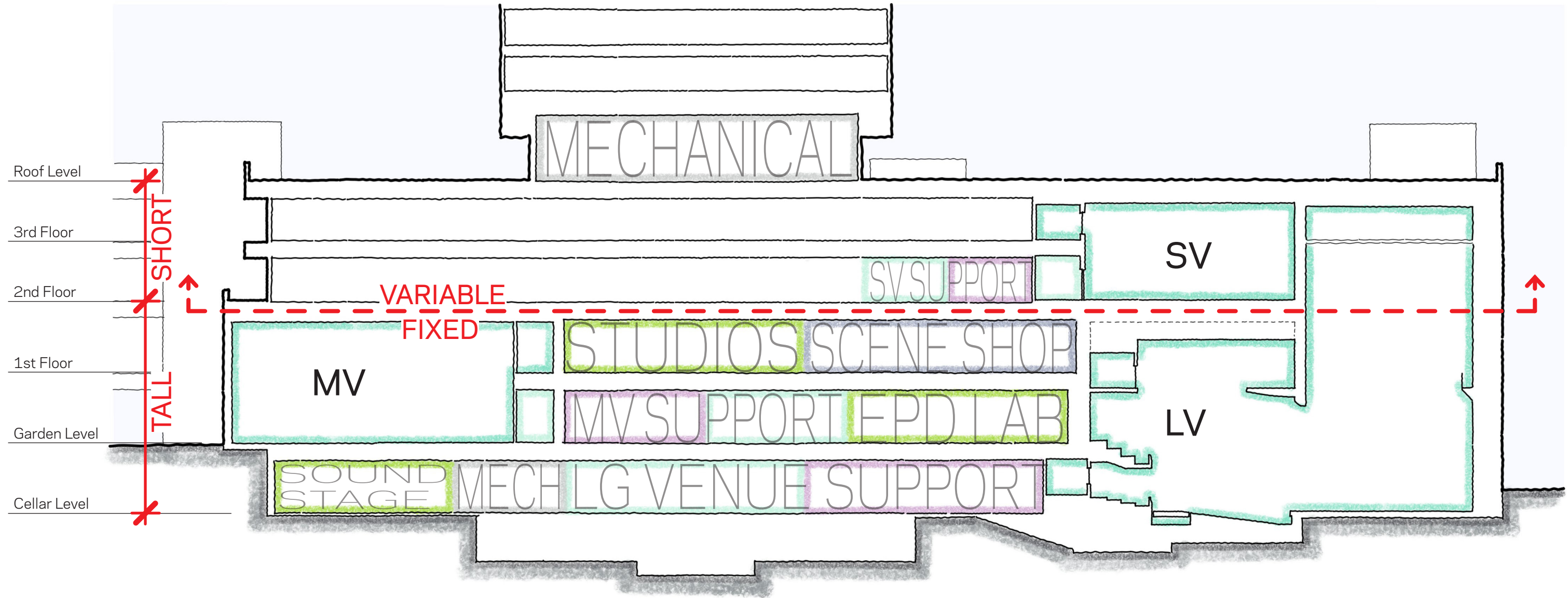

# Current Building Organization

## Summary:

### PPA / ASDS Program:

- Full program accommodated at 1PPE

### Creative Arts Program:

- Art and CMS accommodated at 1PPE and/or 41PR
- FSS mostly accommodated
  - 16mm Production, and FSS Offices not accommodated

### Food Service:

- Ghost Kitchen and Lobby Concept accommodated at 1PPE

### University Maker Space:

- Hard and Soft Fabrication, and Podcasting, accommodated at 1PPE
- Digital Fabrication accommodated at 41PR

### General Academic:

- (4) General Classrooms accommodated at 1PPE
- (11) General Classrooms not accommodated

### ITS:

- Ed Media Suite and Academic Tech accommodated at 1PPE
- Network Services, PM Offices, Telecommunications not accommodated

# Cellar Level

- PUBLIC AREAS
- EVENT/THEATER SPACES
- STAGE SUPPORT
- PERFORMER SUPPORT
- PRODUCTION SHOPS
- PPA/ASDS FACULTY OFFICES
- PPA/ASDS EDUCATION
- CREATIVE ARTS
- ACADEMIC CLASSROOMS
- NON-ACADEMIC
- UNIVERSITY MAKERSPACE

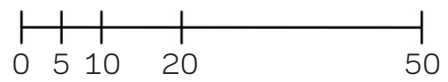

# Garden Level

- PUBLIC AREAS
- EVENT/THEATER SPACES
- STAGE SUPPORT
- PERFORMER SUPPORT
- PRODUCTION SHOPS
- PPA/ASDS FACULTY OFFICES
- PPA/ASDS EDUCATION
- CREATIVE ARTS
- ACADEMIC CLASSROOMS
- NON-ACADEMIC
- UNIVERSITY MAKERSPACE

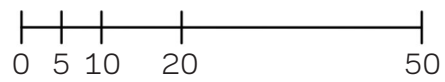
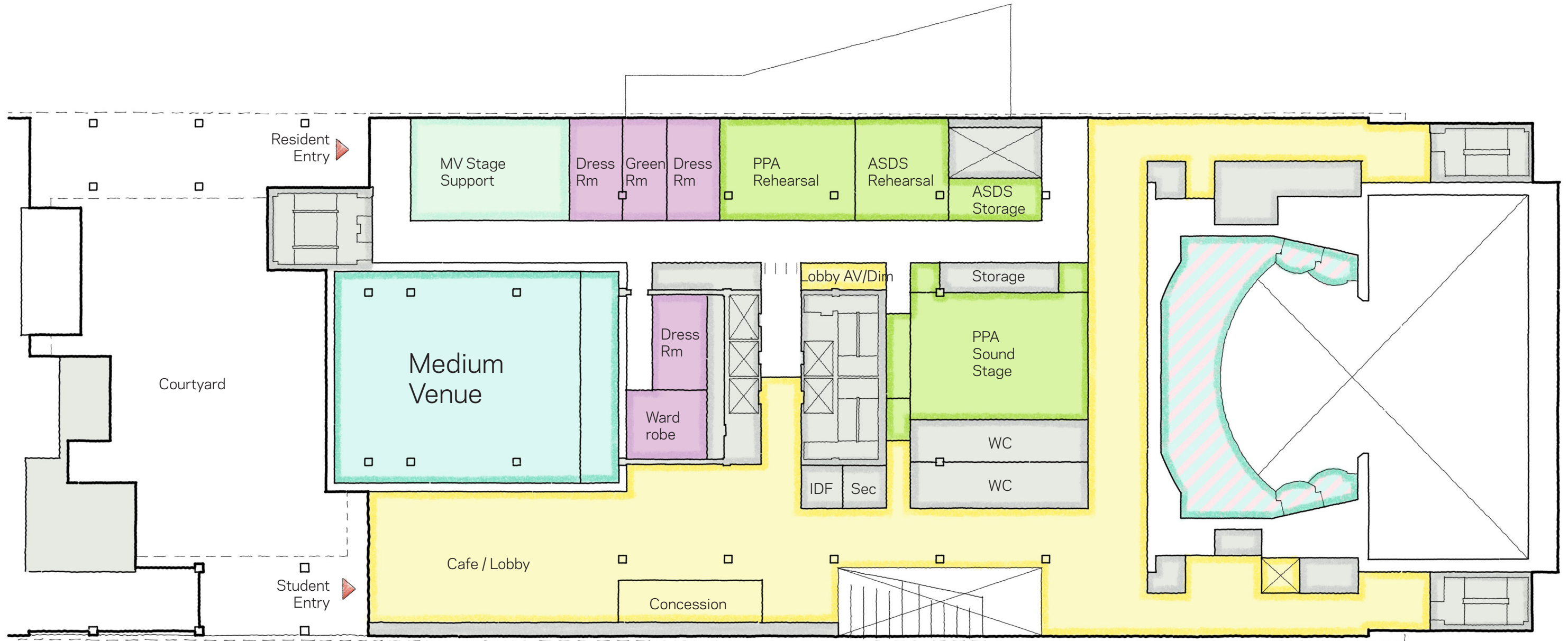

# First Floor

- PUBLIC AREAS
- EVENT/THEATER SPACES
- STAGE SUPPORT
- PERFORMER SUPPORT
- PRODUCTION SHOPS
- PPA/ASDS FACULTY OFFICES
- PPA/ASDS EDUCATION
- CREATIVE ARTS
- ACADEMIC CLASSROOMS
- NON-ACADEMIC
- UNIVERSITY MAKERSPACE

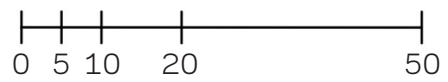
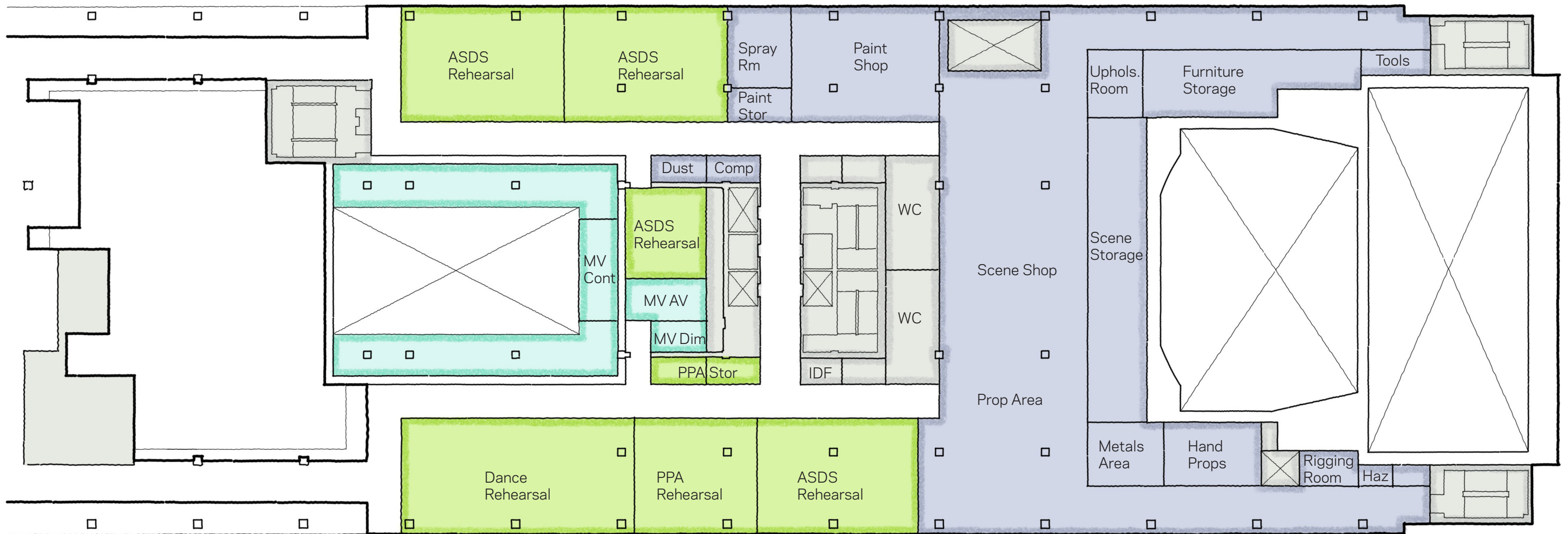



# Second Floor

- PUBLIC AREAS
- EVENT/THEATER SPACES
- STAGE SUPPORT
- PERFORMER SUPPORT
- PRODUCTION SHOPS
- PPA/ASDS FACULTY OFFICES
- PPA/ASDS EDUCATION
- CREATIVE ARTS
- ACADEMIC CLASSROOMS
- NON-ACADEMIC
- UNIVERSITY MAKERSPACE

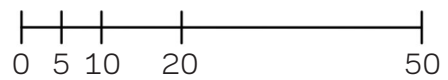
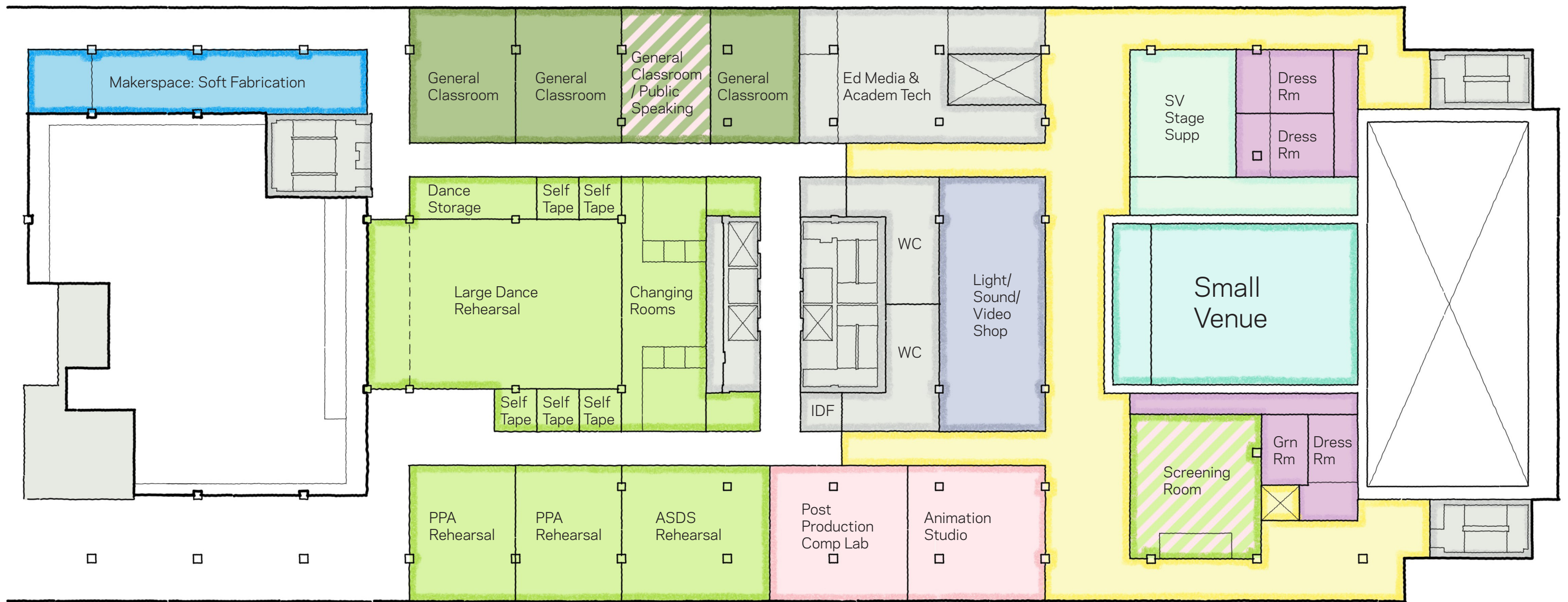

# Third Floor

- PUBLIC AREAS
- EVENT/THEATER SPACES
- STAGE SUPPORT
- PERFORMER SUPPORT
- PRODUCTION SHOPS
- PPA/ASDS FACULTY OFFICES
- PPA/ASDS EDUCATION
- CREATIVE ARTS
- ACADEMIC CLASSROOMS
- NON-ACADEMIC
- UNIVERSITY MAKERSPACE

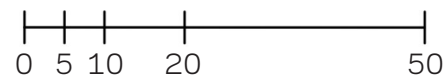
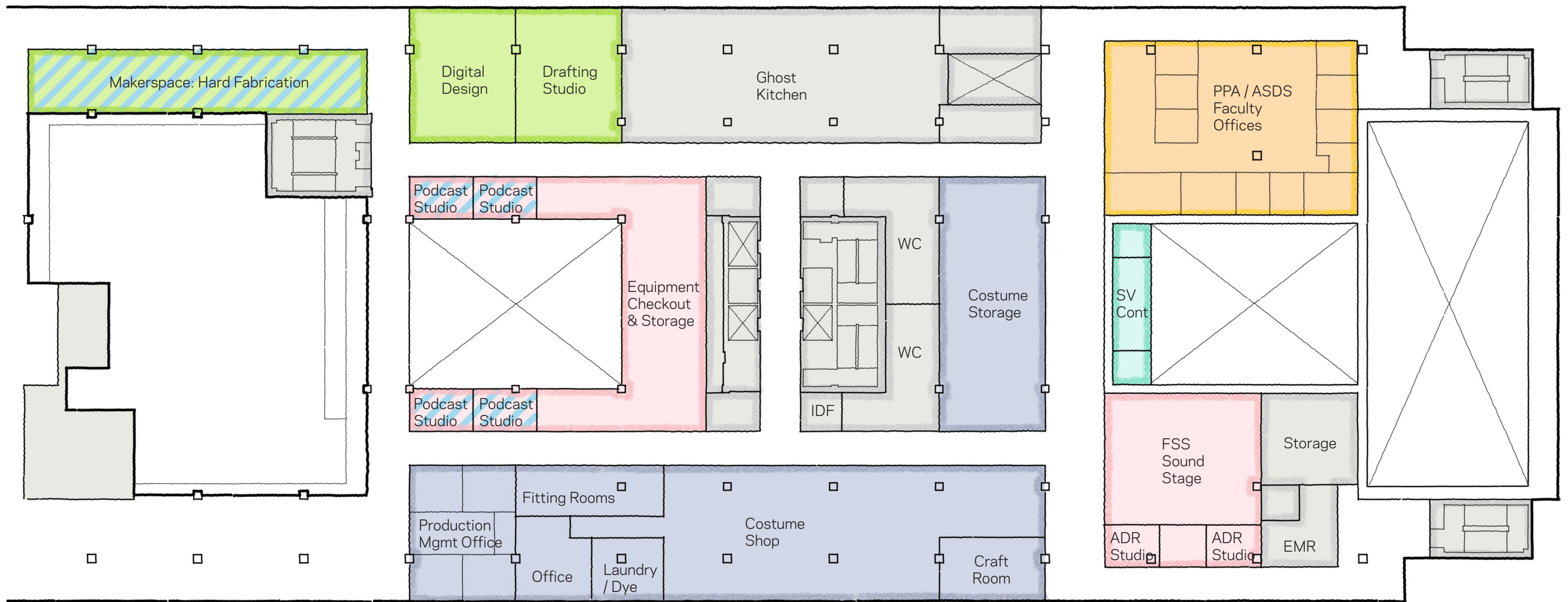

# 41 Park Row



10th Floor

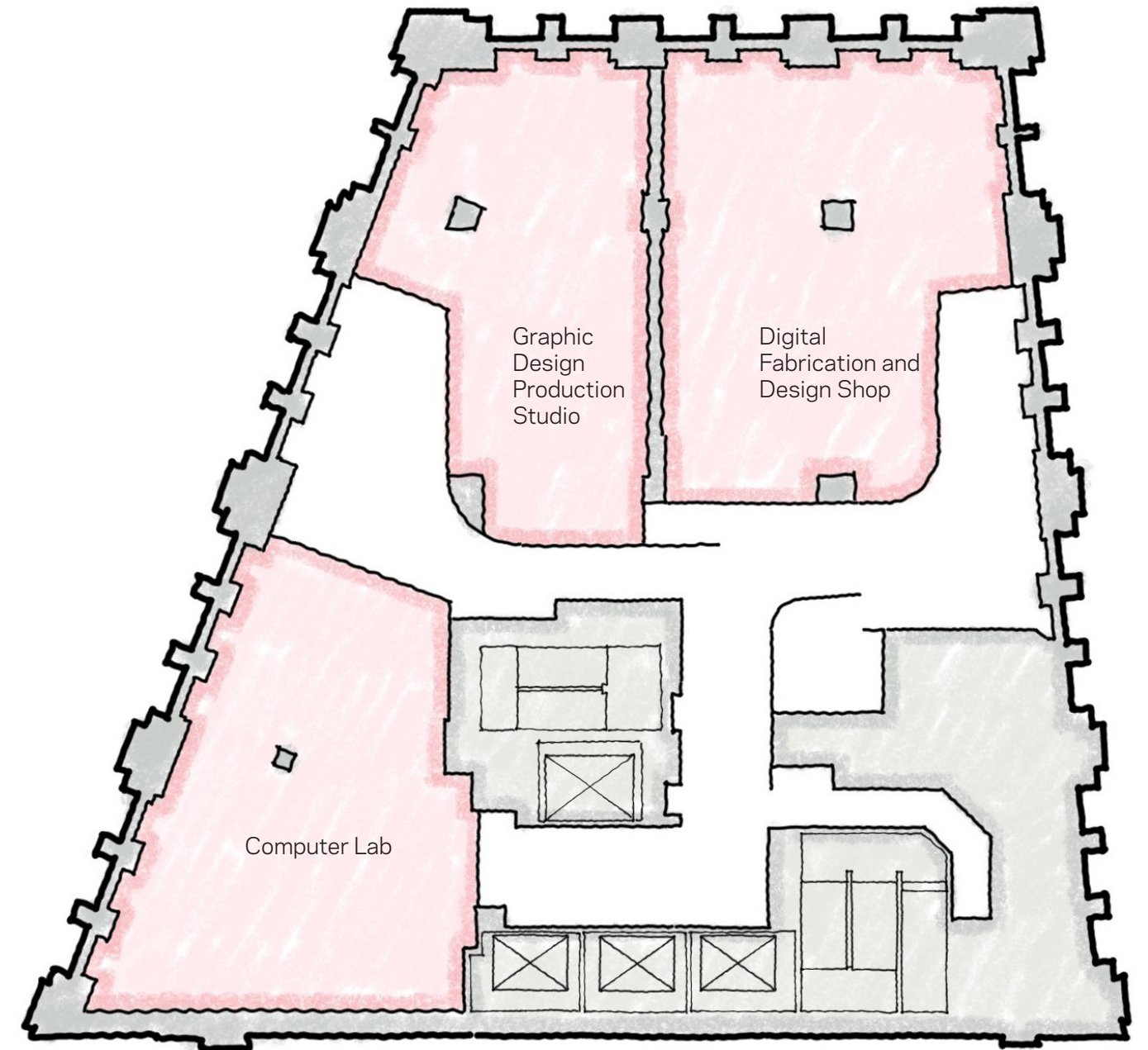
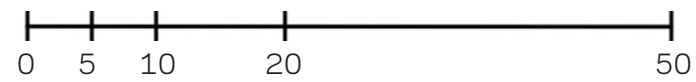

13th Floor

## Shared Programs:

<b>Program</b>	<b>User Groups</b>	<b>Location</b>
Digital Fabrication & Design Shop	Art / FSS / University	41PR
Computer Lab	Art / CMS	41PR
Animation Studio	Art / FSS	1PPE
Maker Space / Hard Fabrication	PPA / University	1PPE
Large Venue / Cinema	PPA / FSS / University	1PPE
LV Dressing Rooms / Make-Up Studio	PPA / FSS / University	1PPE
Screening Room	PPA / FSS	1PPE
Pod Casting Booths	CMS / University	1PPE
General Classroom / Public Speaking Classroom	CMS / University	1PPE

# Summary

Program	1PPE	Shared	Not Accounted
<b>Venues</b>			
Public Areas	▪		
Theaters	▪	▪	
Stage Support	▪		
Performer Support	▪	▪	
<b>PPA / ASDS</b>			
Scene / Prop Shop	▪		
Paint Shop	▪		
Light / Video Shop	▪		
Costume Shop	▪		
PPA / Dance Rehearsal	▪		
ASDS Rehearsal	▪		
Changing Rooms	▪		
Screening Room	▪	▪	
PPA Sound Stage	▪		
Light Lab	▪		
Design / Drafting	▪		
Vocal / Self Tape	▪		
Faculty Offices	▪		
<b>General</b>			
(4) General Classrooms	▪		
(11) General Classrooms			▪
Food - Ghost Kitchen	▪		
Food - Lobby Concept	▪		
Ed Media / Acad Tech	▪		
Maker Space	▪	▪	

Program	1PPE	Shared	41PR	Not Accounted
<b>Creative Arts: Art</b>				
Graphic Design Studio			▪	
Computer Lab		▪	▪	
Animation Studio	▪	▪		
Digital Fab Shop		▪	▪	
<b>Creative Arts: FSS</b>				
FSS Sound Stage	▪			
Large Venue Cinema	▪	▪		
Equipment Checkout	▪			
Post Production Lab	▪			
Makeup Studio	▪	▪		
Animation Studio	▪	▪		
Digital Fab Shop		▪	▪	
Screening Room	▪	▪		
16mm Production				▪
FSS Faculty Offices				▪
ADR Recording Studios	▪			
<b>Creative Arts: CMS</b>				
TV Studio			▪	
Computer Media Lab		▪	▪	
Pod Casting Booths	▪	▪		
CMS Faculty Offices			▪	
Public Speaking	▪	▪		
WPUB Radio Station			▪	
Pace Press			▪	

**Total Program**

Space	Area Requested	Area Provided (Current Scheme)	Bldg	Shareability		
<b>Public Areas</b>						
<b>Lobbies</b>						
Weather vestibules	170	170	1PPE			
Lobby - level 1	6,291	8,043				
Lobby - level 2	1,350	5,332				
<b>Ticketing and customer services</b>						
Sales windows	150	330	1PPE			
Office - House & Box Office Manager	120					
Office - Director of Operations	120					
Storage - box office	80			80		
Coat check/IR system distribution	117					
<b>Concessions</b>						
Concessions/bars - level 1	400	230	1PPE			
Storage - concessions/bar - level 1	60	100				
Cool storage - concessions/bar - 1	20					
Concessions/bars - level 2	80					
Storage - concessions/bar - level 2	20					
Cool storage - concessions/bar - 2	10					
<b>Restrooms</b>						
Restroom - level 1 - men	375	3,400	1PPE			
Restroom - level 1 - women	640					
Restroom - level 1 - unisex	65					
Janitors' closet - level 1	40					
Restroom - level 2 - men	83					
Restroom - level 2 - women	160					
Restroom - level 2 - unisex	65					
Janitors' closet - level 2	40					
<b>Storage</b>						
Storage - FOH operations/furniture	120			200	1PPE	
Storage - technical equipment	100					
Storage - program dispersal - level 1	20					
Storage - program dispersal - level 2	20					
<b>Services</b>						
Dimmer room - lobby	95	120	1PPE			
Audio rack room - lobby	55					
<b>Total Net- Public Areas</b>	<b>10,866</b>	<b>18,005</b>				

**Event/Theater Spaces**

**Proscenium Theatre**

<b>Auditorium</b>					
Orchestra floor	3,000	2,892	1PPE	Shared space, also used as Large Venue Cinema (500 seat) for screenings	
Balcony 1	1,150	1,606			
Auditorium SLLs	324	324			
<b>Stage</b>					
Stage	3,230	2,978	1PPE		
Apron	220	220			
Technical circulation corridor	676	445			
Stage SLL USR	48	48			
Stage SLL USL	48	48			
Stage SLL DSR	48	48			
Stage SLL DSL	48	48			
<b>Understage</b>					
<b>Control rooms</b>					
Control - light	120	225			
Control - sound	120				

**Total Program**

Space	Area Requested	Area Provided (Current Scheme)	Bldg	Shareability
Control - stage manager	100	100	1PPE	
Control - projection	100	100		
Viewing room - director/staff	80	80		
Followspot room	225	225		
Followspot SLLs	48	48		
<b>Services</b>				
Dimmer room	170	170	1PPE	
Amp rack room	95	95		
<b>Net Subtotal - Proscenium Theatre</b>	<b>9,850</b>	<b>9,500</b>		

**Medium Theatre**

<b>Auditorium</b>				
Main floor - auditorium	2,430	1,900	1PPE	
Technical Balcony	950	975		
Auditorium SLLs	288	200		
<b>Stage</b>				
Main floor - performance area	1,080	925	1PPE	
Technical circulation corridor	392			
Stage SLL USR	48			
Stage SLL USL	48			
<b>Control rooms</b>				
Control - light/sound/stage mgr shared	200	187	1PPE	
Control - projection	80			
Control room SLLs	48			
Viewing room - director/staff	80			
<b>Services</b>				
Dimmer room	120	120	1PPE	
Sound rack room	80	85		
<b>Net Subtotal - Medium Theatre</b>	<b>5,844</b>	<b>4,472</b>		

**Black Box Theatre**

<b>Auditorium and stage</b>				
Stage/Auditorium	1,920	1,920	1PPE	
Stage SLL USR	48	48		
Stage SLL USL	48	48		
Auditorium/Stage SLL DSR	48	48		
Auditorium/Stage SLL DSL	48	48		
<b>Control rooms</b>				
Control - light/sound/stage manager shared	200	257	1PPE	
Control room SLL	48			
<b>Services</b>				
Dimmer room	95	95	1PPE	
Sound rack room	80	80		
<b>Net Subtotal - Black Box Theatre</b>	<b>2,535</b>	<b>2,544</b>		
<b>Total Net - Event/Theater Spaces</b>	<b>18,229</b>	<b>16,516</b>		

**PPA/ASDS**

**PPA/ASDS Education**

<b>PPA Rehearsal Studios</b>				
PPA Rehearsal Studio #1	800	720	1PPE	
PPA Rehearsal Studio #1 - storage	80	60		
PPA Rehearsal Studio #2	800	720		
PPA Rehearsal Studio #2 - storage	80	60		
PPA Rehearsal Studio #3	800	800		
PPA Rehearsal Studio #3 - storage	80	100		
PPA Rehearsal Studio #4	800	800		
PPA Rehearsal Studio #4 - storage	80	100		
<b>Net Subtotal - PPA Acting Spaces</b>	<b>3,520</b>	<b>3,360</b>		
<b>PPA Dance Studios</b>				
Dance Studio #1	2,400	2,400	1PPE	
Dance Studio #2	1,400	1,400		
Storage - custodial equipment & wet closet	130	220		
<b>Net Subtotal - PPA Dance Spaces</b>	<b>3,930</b>	<b>4,020</b>		
<b>ASDS Rehearsal Studios</b>				

**Total Program**

Space	Area Requested	Area Provided (Current Scheme)	Bldg	Shareability
ASDS Rehearsal Studio #1	1,000	1,000	1PPE	
ASDS Rehearsal Studio #2	1,000	1,000		
ASDS Rehearsal Studio #3	1,000	890		
ASDS Rehearsal Studio #4	1,000	1,000		
ASDS Small Rehearsal Studio #1	500	500		
ASDS Small Rehearsal Studio #2	500	400		
Storage - Rehearsal rooms	900	200		
<b>Net Subtotal - ASDS Spaces</b>	<b>5,900</b>	<b>4,990</b>		
<b>Changing Rooms</b>				
Changing room - male	300		1PPE	
Changing room - female	600	1,200		
<b>Net Subtotal - Changing</b>	<b>900</b>	<b>1,200</b>		
<b>Classrooms</b>				
Sound Stage	1,200	1,100	1PPE	
Screening Room	800	1,000		Shared space, also used as FSS Screening Room
Entertainment Production Design / Light Lab	1,500	1,500		
Digital Design	600	800		
Printing Hub	225			
Maker Space	600	1,200		Shared space, also used as Hard Fabrication Space
Drafting Studio	800	800		
Vocal/Self Tape Room #1	100	100		
Vocal/Self Tape Room #2	100	100		
Vocal/Self Tape Room #3	100	100		
Vocal/Self Tape Room #4	100	100		
Vocal/Self Tape Room #5	100	100		
<b>Net Subtotal - Classroom Spaces</b>	<b>6,225</b>	<b>6,900</b>		
<b>Net Subtotal - PPA/ASDS Education Spaces</b>	<b>20,475</b>	<b>20,470</b>		

**Stage Support**

<b>Stage Door / Reception</b>				
Reception	240		1PPE	
Welcome Desk / Security / Fire Control	180			
Storage - holding/receiving lockup	80			
<b>Theatre Loading</b>				
Scene dock - Receiving Interior	400		1PPE	
<b>Stage Support - Proscenium Theatre</b>				
Scene dock / performer waiting	600	600	1PPE	
Storage - rigging	100			
Storage - props	150			
Storage - lighting	100			
Storage - sound	100	860		
Storage - general stage	250			
Storage - piano / instruments	200			
Restroom - offstage	65			
<b>Stage Support - Medium Theatre</b>				
Scene dock / performer waiting	400		1PPE	
Kitchen - props	150			
Storage - rigging	100			
Storage - props	100			
Storage - general stage	200	860		
Storage - piano / musical Instruments	100			
Storage - platforms/chairs	600			
Restroom - offstage	65			
<b>Stage Support - Black Box</b>				
Storage - general stage	200		1PPE	
Storage - piano / musical instruments	120	750		
Storage - platforms/chairs	600			
Restroom - offstage	65			
<b>Net Subtotal - Stage Support</b>	<b>5,165</b>	<b>3,070</b>		



**Total Program**

Space	Area Requested	Area Provided (Current Scheme)	Bldg	Shareability
-------	----------------	--------------------------------	------	--------------

**Theater Support**

Proscenium Theatre				
Dressing room - 2 person	160	230	1PPE	Shared space, also used as Make-up Studio/Dressing Room
Dressing room - 2 person	160	230		
Dressing room - 2 person	160			
Dressing room - 4 person	240	270		
Dressing room - 4 person	240	270		
Dressing room - 10 person	450	450		
Dressing room - 10 person	450	450		
Dressing room - 10 person	450	400		
Green room	462	400		
Wardrobe	240			
Vending	50			
Medium Theatre				
Dressing room - 8 person	360	290	1PPE	
Dressing room - 8 person	360	290		
Dressing room - 8 person	360	290		
Green room	250	240		
Wardrobe	200	320		
Vending	50			
Black Box Theatre				
Dressing room - 4 person	240	230	1PPE	
Dressing room - 4 person	240	230		
Dressing room - 4 person	240	230		
Green room	120	120		
<b>Net Subtotal - Theater Support</b>	<b>5,482</b>	<b>4,940</b>		

**Production Shops**

Scene / Prop Shop (combined)						
Scene shop	3,250	3,600	1PPE			
Prop Area	800					
Upholstery room	225	200				
Metal Area	300	270				
Dust collection	64	60				
Compressor room	64	60				
Storage - tools	200	90				
Storage - materials	600					
Storage - hazardous materials	40	40				
Storage - rigging room	100	110				
Storage - scenery	1,000	1,000				
Storage - hand props	500	340				
Storage - furniture	1,000	610				
Office - combined	250	250				
<b>Net Subtotal - Scene / Prop Shop (combined)</b>	<b>8,393</b>	<b>6,630</b>				
Paint Shop						
Paint shop	1,000	940			1PPE	
Spray booth/exhaust hood	300	280				
Storage - paints	120	120				
<b>Net Subtotal - Paint Shop</b>	<b>1,420</b>	<b>1,340</b>				
Costumes						
Costume shop	2,640	2,400				
Fitting room	320	440				

**Total Program**

Space	Area Requested	Area Provided (Current Scheme)	Bldg	Shareability
Craft room	500	480	1PPE	
Laundry/Dye Room	300	370		
Office - Costume Shop staff	240	240		
Storage - costumes/fabric/shoes	1,800	1,450		
<b>Net Subtotal - Costume Shop</b>	<b>5,800</b>	<b>5,380</b>		
<b>Lighting, Sound &amp; Video</b>				
Lighting Shop / Storage	875	800	1PPE	
Sound and Video Shop / Storage	750	700		
Office - Shared	240	200		
<b>Net Subtotal - Lighting, Sound &amp; Video</b>	<b>1,865</b>	<b>1,700</b>		
<b>Offices and Support Space</b>				
Office - Dean of Production	120	800	1PPE	
Office - Assistant Dean of Production	80			
Office - Graduate PM/Assist PM	120			
Office - Undergraduate PM/Assist PM	120			
Break room	225			
Restroom	65			
Restroom	65			
<b>Net Subtotal - Offices and Support Spaces</b>	<b>795</b>	<b>800</b>		
<b>Net Subtotal - Production Shops</b>	<b>18,273</b>	<b>15,850</b>		

**Faculty Offices**

<b>Administration – PPA</b>				
Office - Communications/Marketing	80	80	1PPE	
Office - Production Design Head	80	80		
Office - Production Design Head	80	80		
Office - Production Design Head	80	80		
Office - Production Design Head	80	80		
Office - Production Design Faculty	120	120		
Office - Adjunct Faculty	450	450		
<b>Administration – ASDS</b>				
Office - Program Manager	80	80	1PPE	
Office - Director of Professional Development	80	80		
Office - General Manager	80	80		
Office - Program Chair & Assoc Chair	120	120		
Office - Faculty Shared/Lounge	150	150		
<b>Administration – Shared</b>				
Reception/Waiting Area	100	100	1PPE	
Small Conference Room	150	150		
Pantry	200	200		
Mother's Room	80			
Faculty Storage	50	50		
Faculty Restroom	65			
<b>Net Subtotal - Faculty Offices</b>	<b>2,125</b>	<b>1,980</b>		
<b>Total Net - PPA/ASDS</b>	<b>51,520</b>	<b>46,310</b>		

**Creative Arts**

<b>Art Department</b>				
Graphic Design Production Studio	1,200	920	41 PR	
Computer Lab	1,000	1,100	41 PR	Shared space, also used as CMS Computer Media Lab
Animation Studio	1,300	1,000	1 PPE	Shared space, also used as FSS Animation Studio
Digital Fabrication and Design Shop	1,750	1,200	41 PR	Shared space, also used as FSS Digital Fab Shop
<b>Net Subtotal - Art Department</b>	<b>5,250</b>	<b>4,220</b>		
<b>Film and Screen Studies</b>				
Medium Venue Sound Stage	4,000	1,000		

**Total Program**

Space	Area Requested	Area Provided (Current Scheme)	Bldg	Shareability
Large Venue Cinema (500 Seat) for screenings	TBC	2,892	1 PPE	Shared space, also used as Large Venue
Equipment Check Out and Storage	1,500	1,600	1 PPE	
Post-Production Computer Lab & Editing Suites	1,200	1,000	1 PPE	
Make-up Studio/Dressing Room	600	600	1 PPE	Shared space, also used as Performer Support
Animation Studio	1,300	1,000	1 PPE	Shared space, also used as Art Dept Animation Studio
Digital Fabrication Shop and Computer-Aided Design Lab	1,750	1,200	41 PR	Shared space, also used as Art Dept Digital Fab/Design
Screening Room (Tiered Seating, Raised Stage & 16mm Projection Booth)	1,150	1,000	1 PPE	Shared space, also used as Screening Room
16mm Film Production Facility	1,450			
FSS Offices (Chair +3) & Conference Room	800			
ADR Recording Studios (2)	400	260	1 PPE	
<b>Net Subtotal - Film and Screen Studies Department</b>	<b>14,150</b>	<b>10,552</b>		
<b>Communication and Media Studies</b>				
TV Studio (with control booth & storage)	1,600	1,400	41 PR	
Computer Media Lab	900	1,100	41 PR	Shared space, also used as Art Dept Computer Lab
Pod Casting Booths (4)	600	600	1 PPE	Shared space, also used as Podcast Annex (275sf)
Pace Press Newsroom	800	750	41 PR	
Faculty Offices (2)	300	330	41 PR	
Public Speaking Classroom (with stage & tiered seating)	800	600	1 PPE	Shared space, also used as General Classroom
WPUB Radio Station	500	450	41 PR	
<b>Net Subtotal - Communication and Media Studies Department</b>	<b>5,500</b>	<b>5,230</b>		
<b>Total Net - Creative Arts</b>	<b>24,900</b>	<b>20,002</b>		

**Academic Classrooms**

General Purpose Classrooms				
General Purpose Classroom 1	725	750	1 PPE	Shared space, also used as Public Speaking Classroom
General Purpose Classroom 2	725	750		
General Purpose Classroom 3	725	600		
General Purpose Classroom 4	725	600		
General Purpose Classroom 5	725			
General Purpose Classroom 6	725			
General Purpose Classroom 7	725			
General Purpose Classroom 8	725			
General Purpose Classroom 9	725			
General Purpose Classroom 10	725			
General Purpose Classroom 11	725			
General Purpose Classroom 12	725			
General Purpose Classroom 13	725			
General Purpose Classroom 14	725			
General Purpose Classroom 15	725			
<b>Total Net - Academic Classrooms</b>	<b>10,875</b>	<b>2,700</b>		

**Non-Academic**

Security				
----------	--	--	--	--

**Total Program**

Space	Area Requested	Area Provided (Current Scheme)	Bldg	Shareability
Security Offices	1,000	1,000	1PPE	
Maria's Tower Attendant	60			
<b>Student Use</b>				
Meditation Room	300			
Conference Room	340			
<b>Buildings &amp; Grounds</b>				
Loading Dock	760	760		
Buildings & Grounds Storage	110	110		
Storage	90		1PPE	
Closet	60	60		
CBS Offices and Lockers	1,300			
<b>Mail Services</b>				
Mail Room & Storage	900	610		
Student Mail Room	200	210		
University Mail Room	200		1PPE	
Digital Lockers for Students (2)	40			
<b>Operations</b>				
Bookshop Storage	474	450		
Cleaning Equipment Storage	500			
Mechanical Storage	500	480	1PPE	
Watch Engineer	80	140		
Chemical Storage	170	160		
<b>ITS</b>				
Education Media & Academic Tech Offices	2,500	1,500		
IT IDF Rooms (5)	500	500	1PPE	
<b>Food Services</b>				
Virtual Food Hall/Ghost Kitchen	2,200	2,400	1PPE	
Lobby Concept	725	400		
<b>Total Net - Non-Academic</b>	<b>13,009</b>	<b>8,780</b>		

**University-wide Makerspace**

Space	Area Requested	Area Provided (Current Scheme)	Bldg	Shareability
<b>Pace Makerspace (11/15/2022)</b>				
Hard Fabrication Space	1,300	1,050	1PPE	Shared space, also used as PPA Makerspace
Soft Fabrication Space	900	1,200	41PR	
Digital Fabrication Space	600	1,200	41PR	Shared space, also used as Digital Design Lab
Podcast Annex	275	275	1PPE	Shared space, also used as Pod Casting Booths (275sf)
Office	150	150		
<b>Total Net - University-wide Makerspace</b>	<b>3,225</b>	<b>3,875</b>		
<b>Total Net Area</b>	<b>132,624</b>	<b>116,188</b>		